

DOORSNEDE AA.

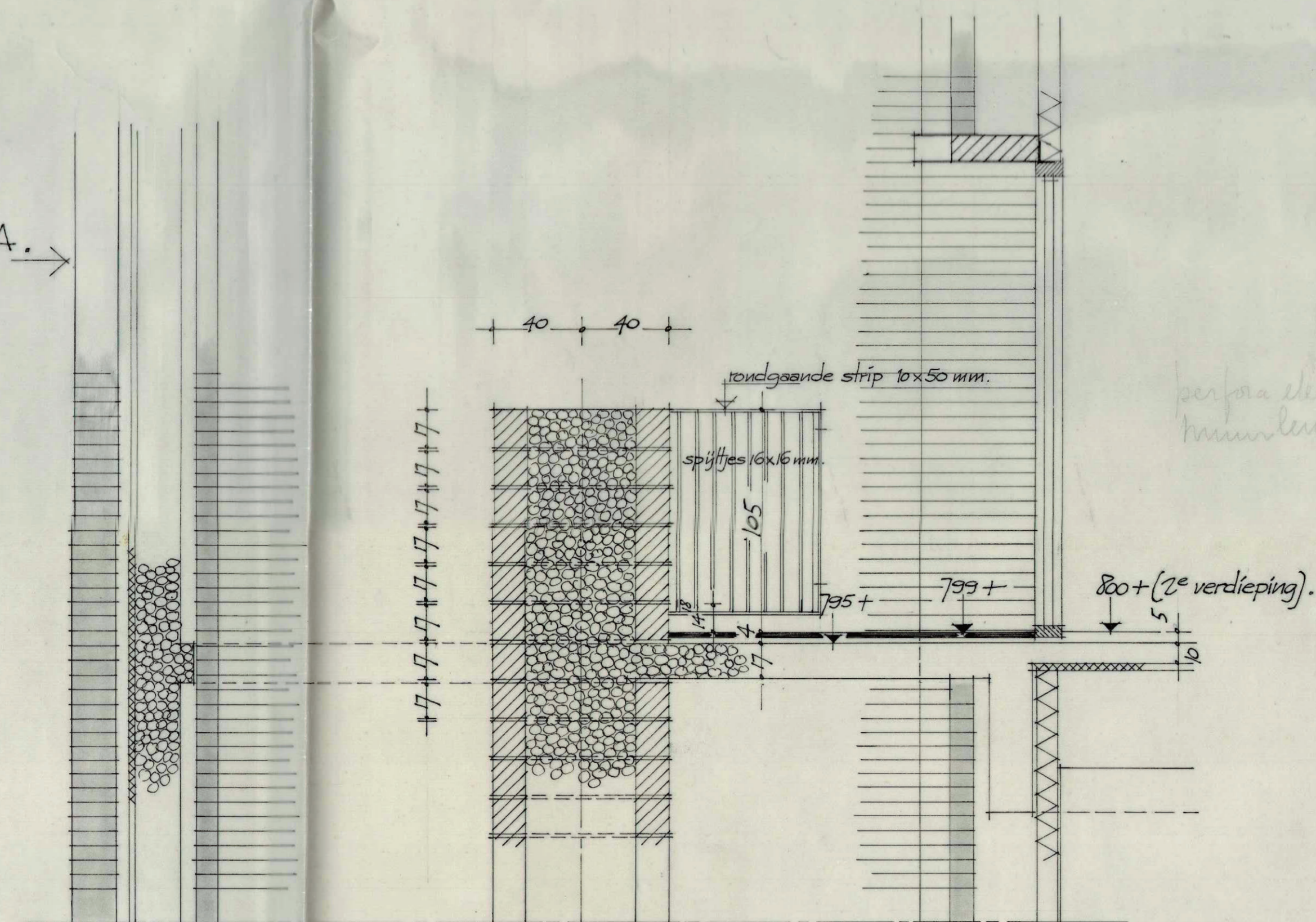

DOORSNEDEN OVER KOZIJN MERK C.

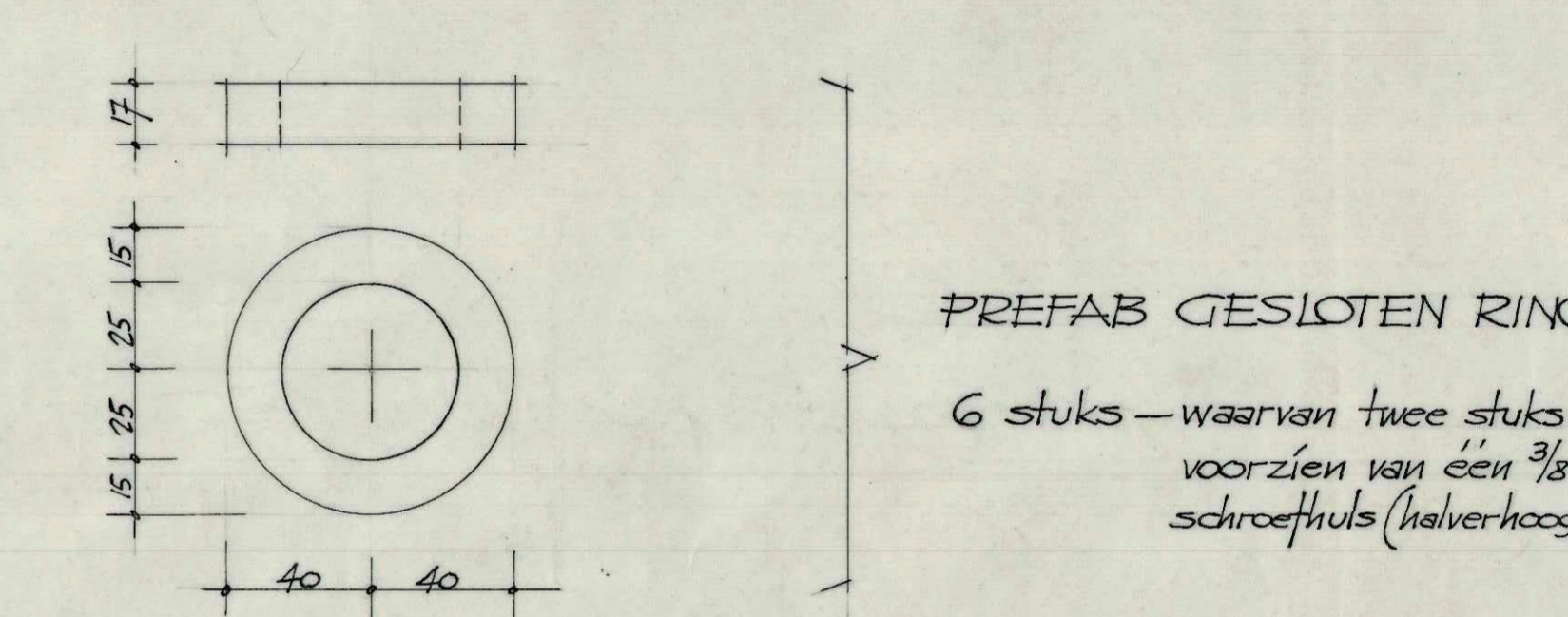
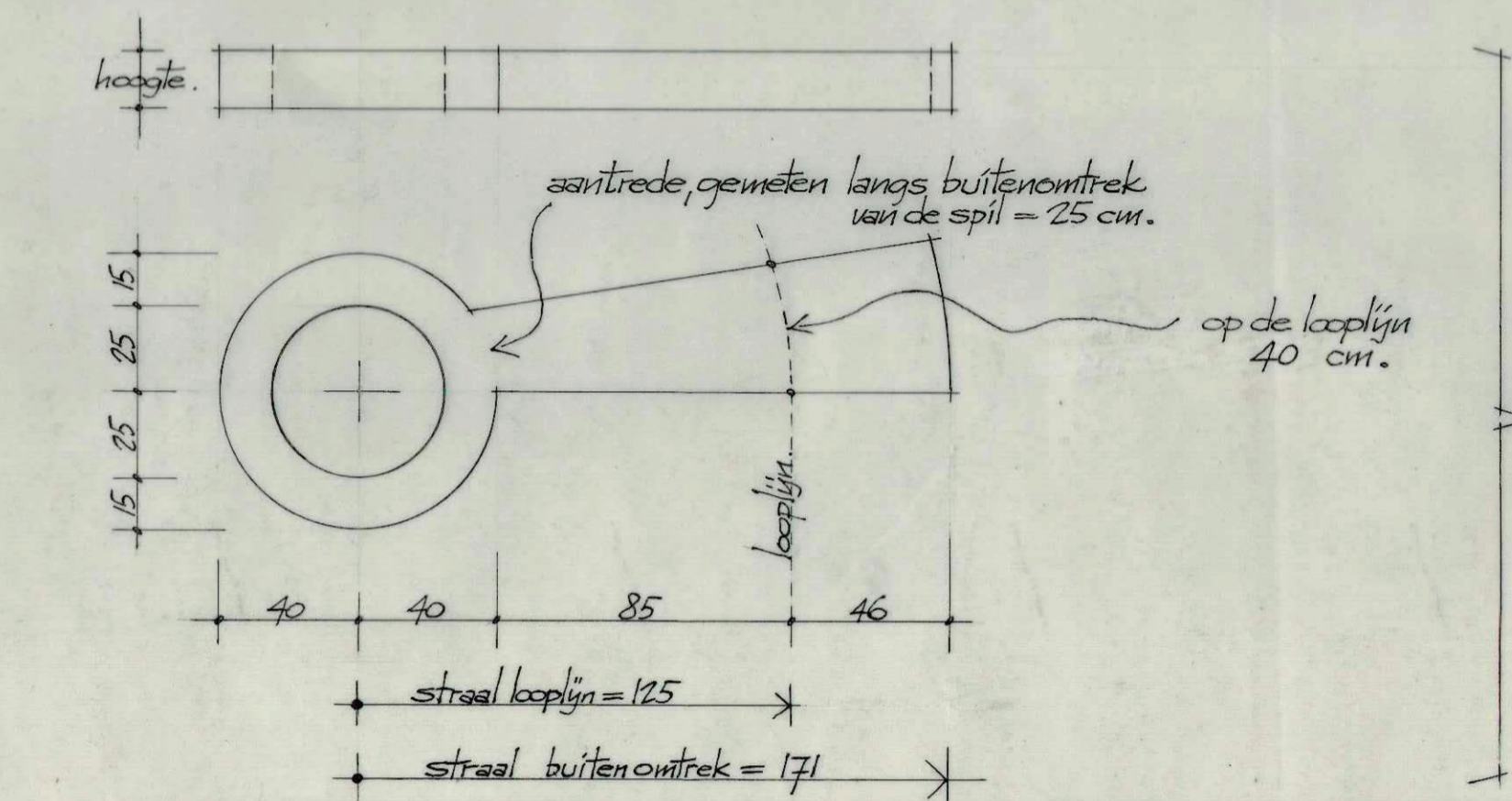
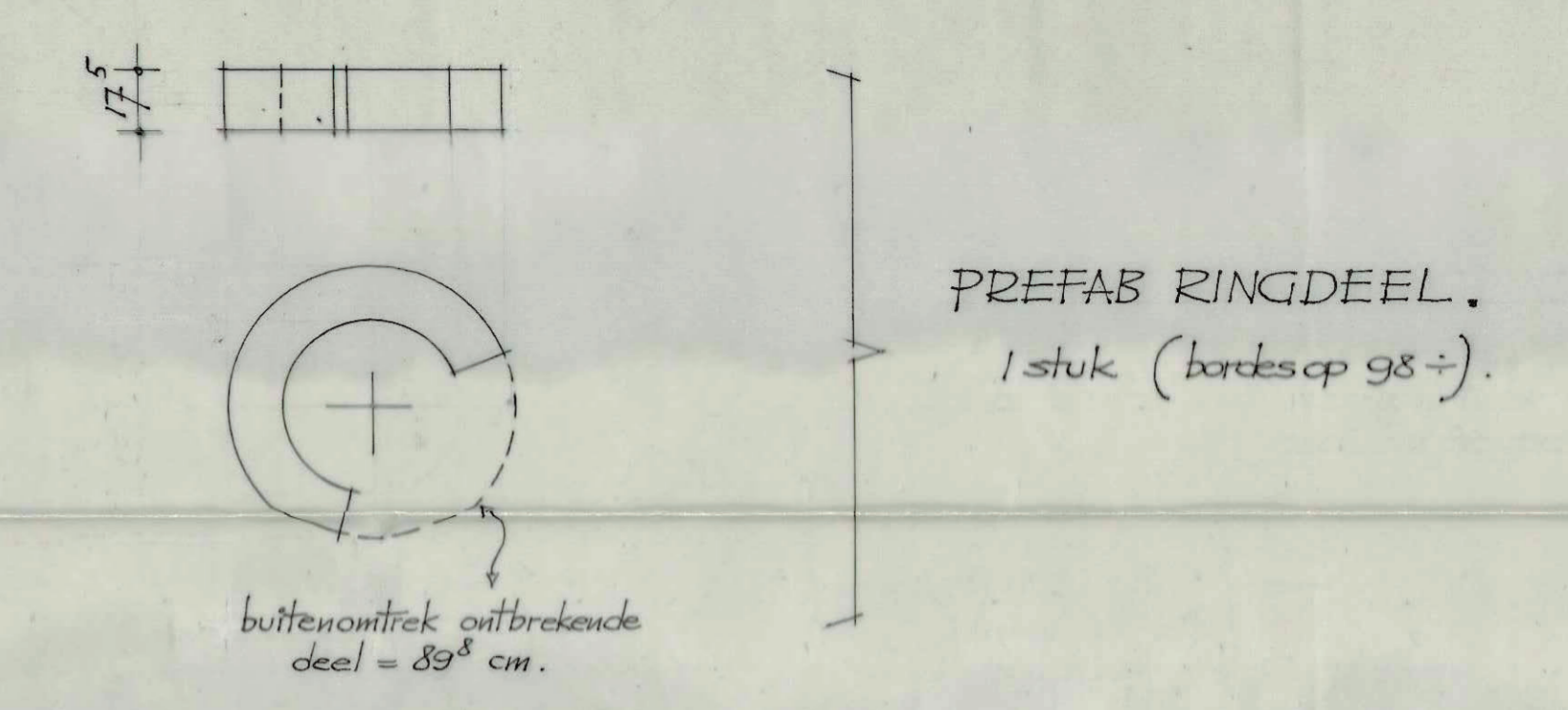
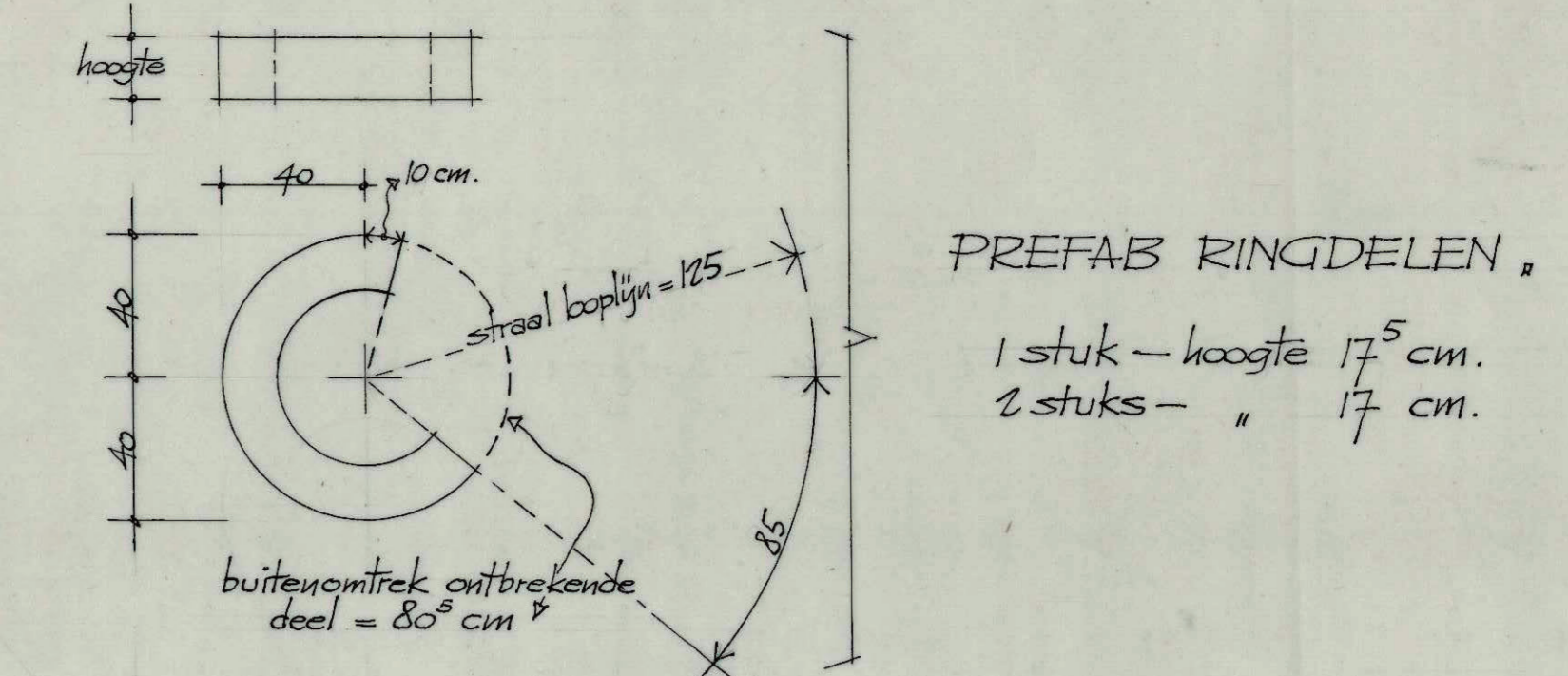
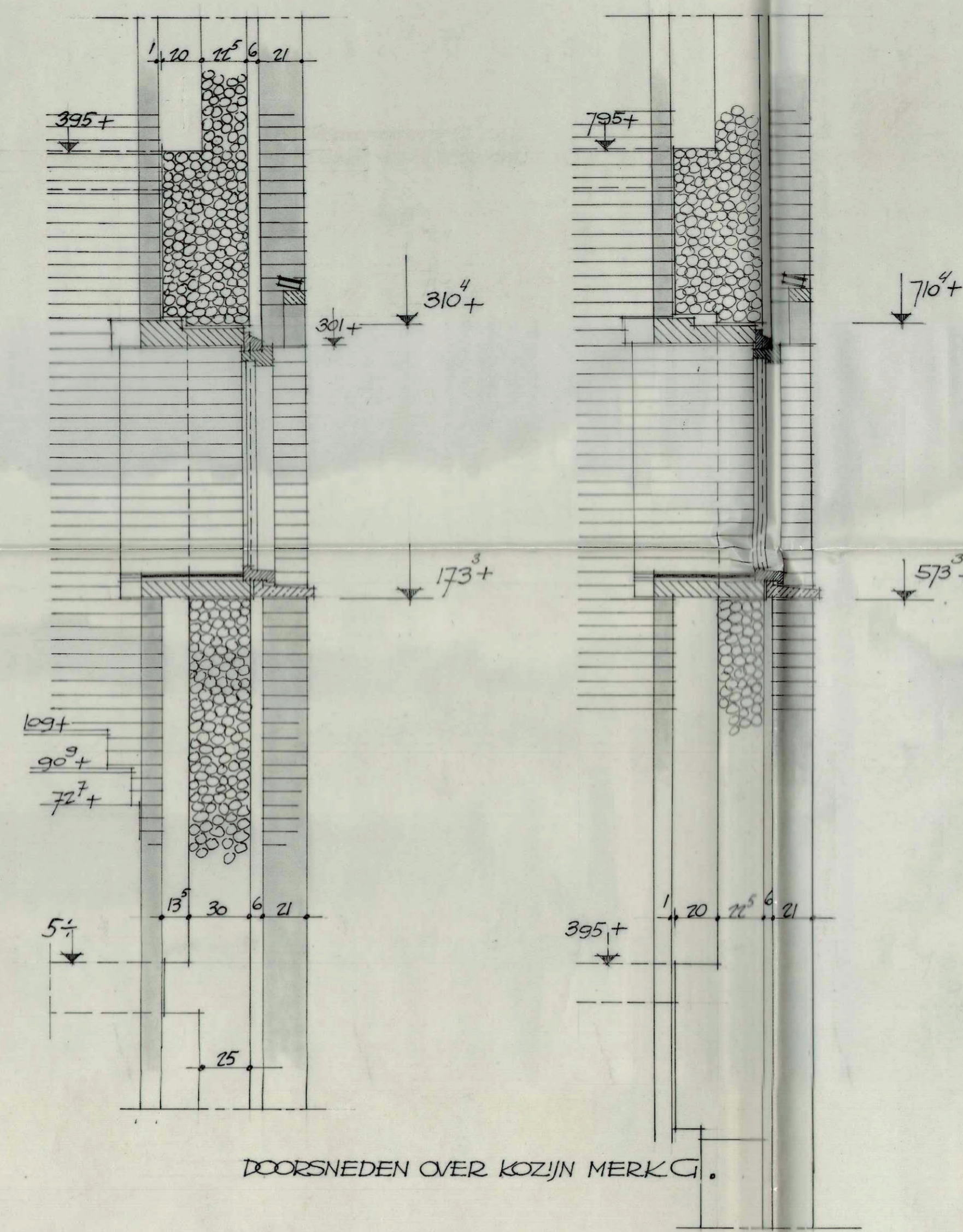

VOOR DOORSNEDEN X-X/Y-Y/Z-Z ETC ZIE DE BEIENDEKENINGEN.

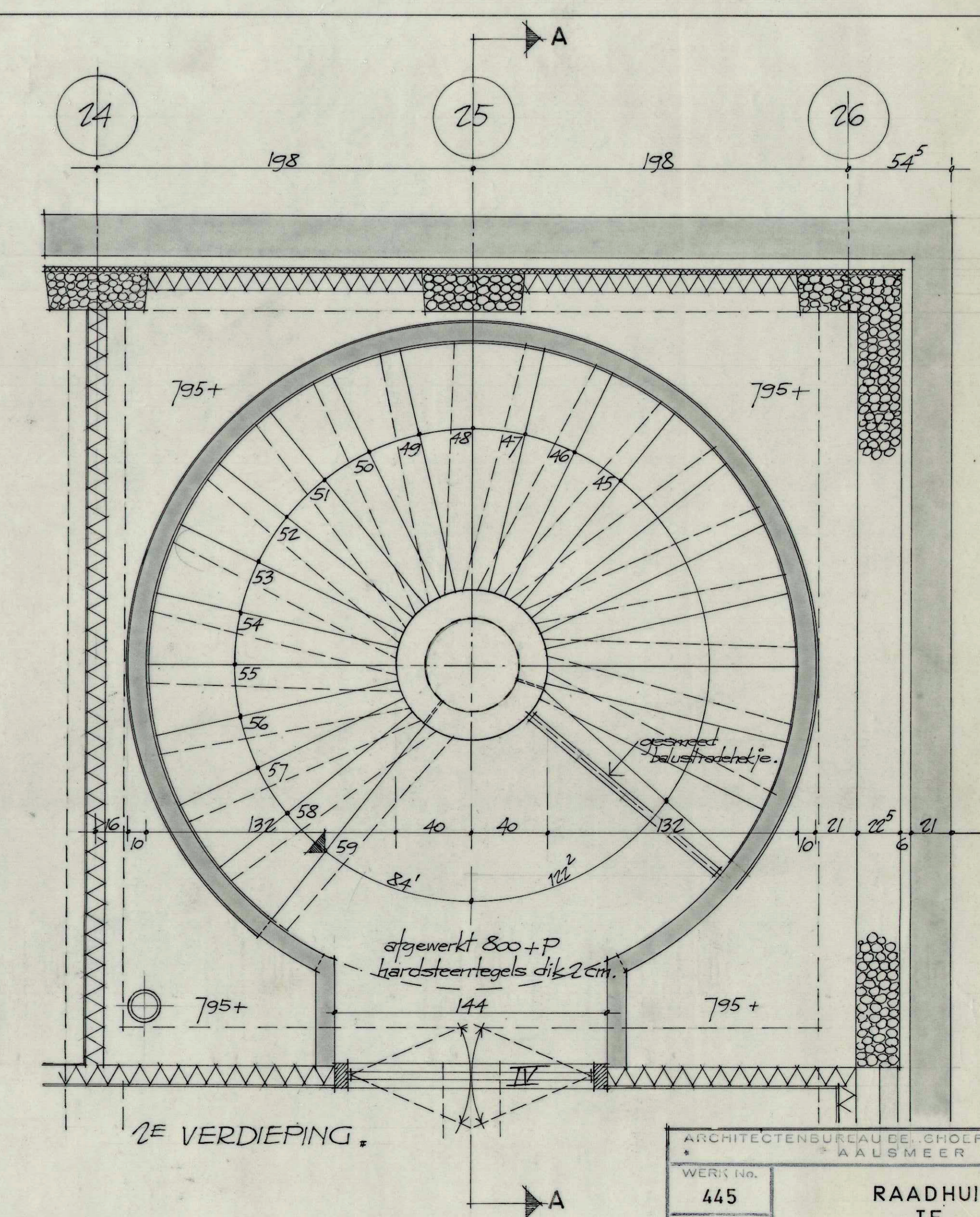
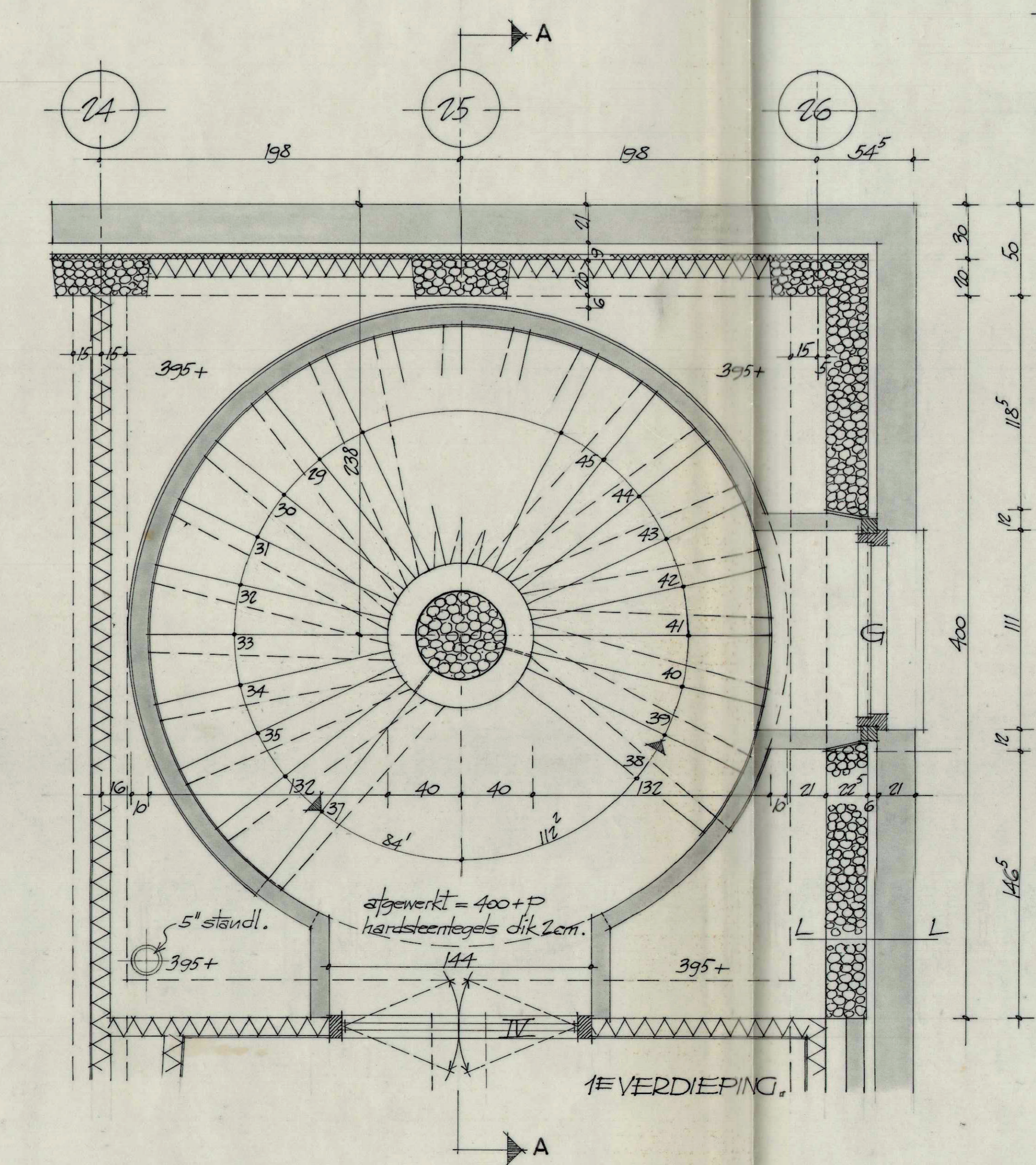
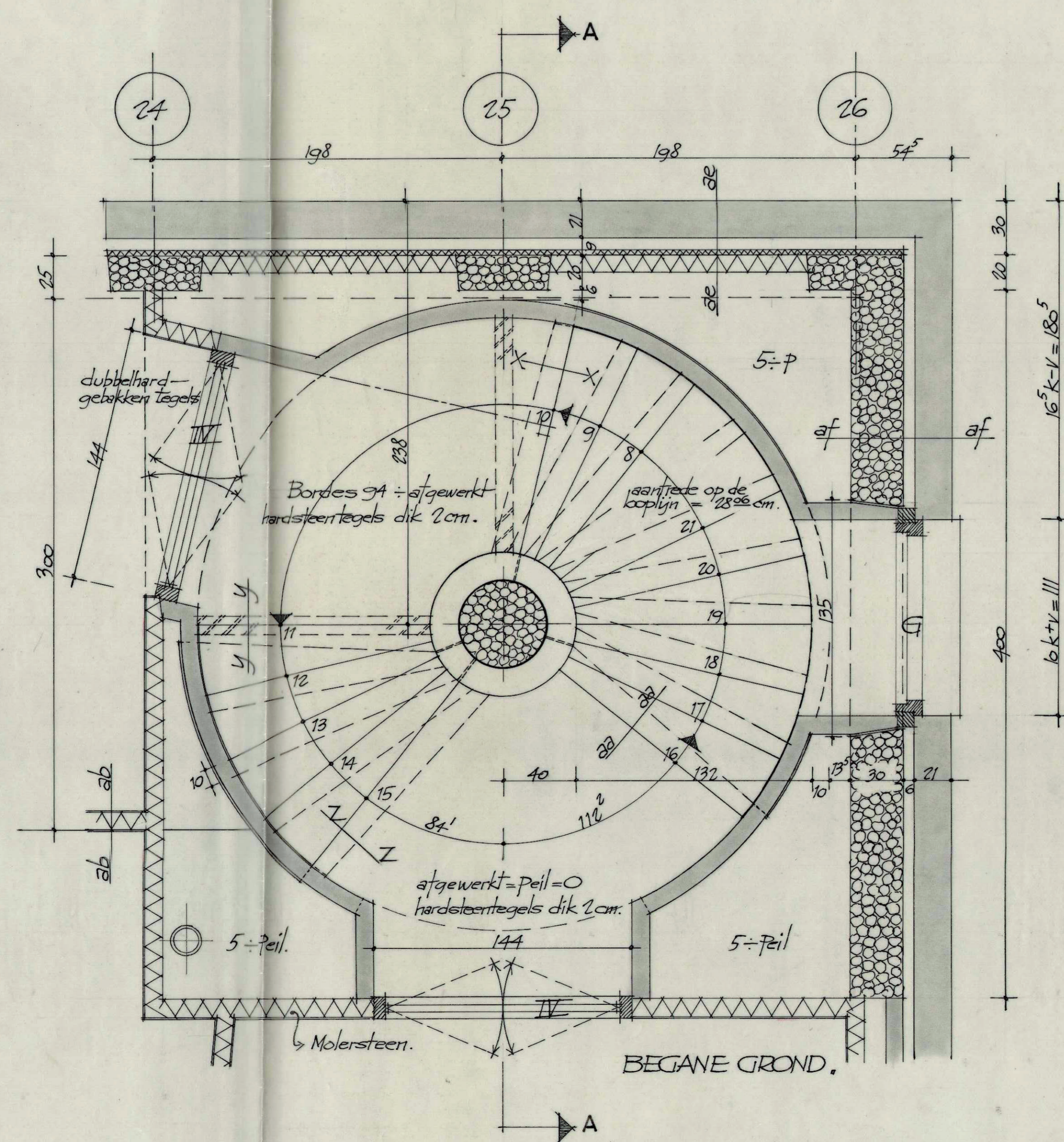
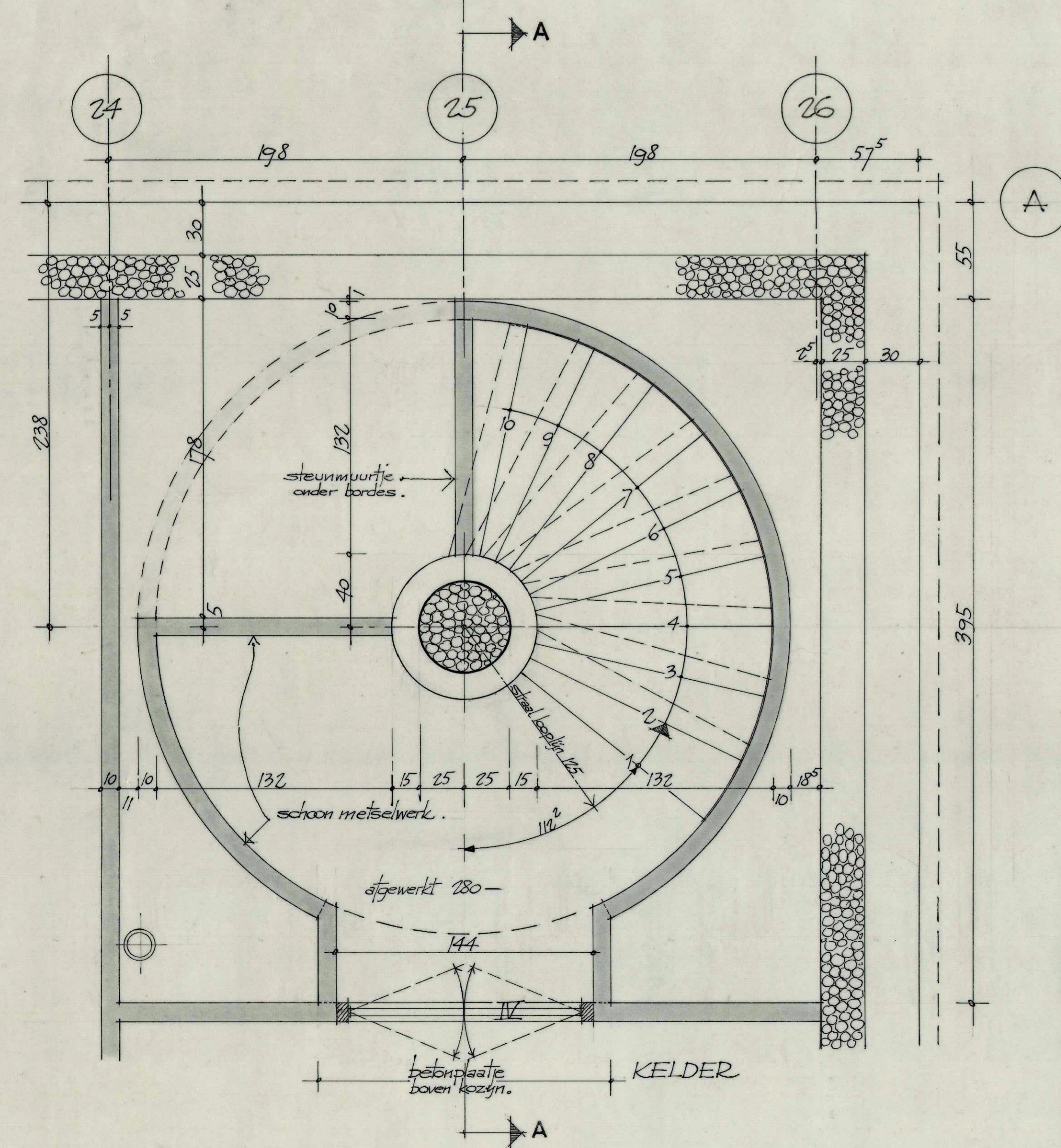

ARCHITECTENBURO DE GOLF & KLARENBEER AALSMEER	
WERK NO. 445	RAADHUIS TE ALBLASSERDAM
SCHAAL 1 A 20	GEZ. T. REID April '62 S. VALERIO V. VANST
OVERZICHT DIENST-TRAP	
BLAD NO. 6C-1	